

AG1000L-FP SERIES FIRE PUMP GAUGES

ALLENCO® Allenco Series AG-1000L

Liquid Filled Fire Pump Suction and Discharge Gauges

Our Allenco Series AG-1000L-FP liquid filled gauges were specifically designed for use with fire pumps. These high quality gauges are 1% accurate over the entire gauge range and are manufactured to conform to both ANSI B40.1 Grade 1A standards and NFPA 20-2013(14.2.6.1.2.2) as it relates to gauge accuracy requirements for field acceptance testing.

The standard glycerin filling helps dampen the effects of pump vibration while also lubricating the gauge movement which helps to extend the gauge life. Gauges are labeled on the dial face as "Fire Pump Suction" for the 30"/0/150 PSI range and "Fire Pump Discharge" for other available ranges.



Specifications

- Dial Size: 4"
- Connection Size: 1/4" (M) NPT
- Stainless Steel Case and Bezel
- Brass Internals and Connection
- Phosphor Bronze Bourdon Tube
- Liquid Filled
- Accuracy: 1%
- Dual Scale: PSI & BAR (x100=kPa)
- Ambient Temperature: 30°F to 160°F

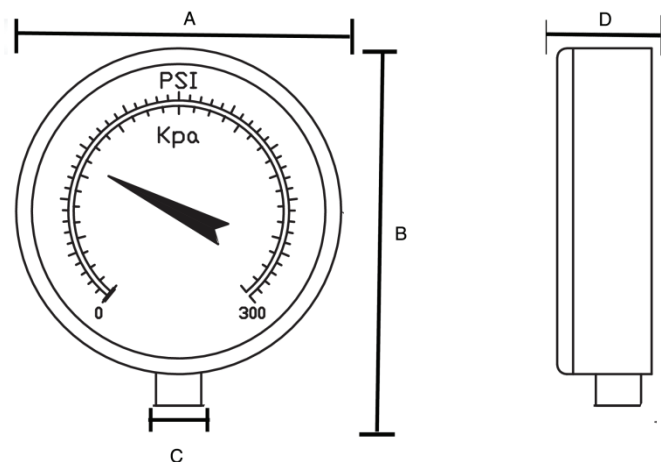

PSI Range	Major Inc.	Minor Inc.
30"/0/150	20	2
0/300	50	5
0/400	50	5
0/600	100	10

	A	B	C	D
In.	4.32"	5.57"	1/4"	1.25"
MM	110	141	MNPT	32